

Reference	Species	DBH	Condition	Comments	Located within 200' Riverfront Buffer	Status
T1	Sugar Maple	30	Fair	Prune dead wood	Yes	Protect
T2	Sugar Maple	6	Good		Yes	Protect
T3	Sugar Maple	28	Poor	Prune dead wood	Yes	Protect
T4	Sugar Maple	22	Dead		Yes	Remove
T5	Cottonwood	15	Good	Volunteer Succession Tree	Yes	Protect
T6	Norway Maple	24	Fair	Topped, missing central leader	No	Protect
T7	White Pine	26	Poor	Inside Proposed Building	No	Remove
T8	White Pine	24	Dead		Yes	Remove
T9	White Pine	30	Poor	Path and Grading Conflicts	Yes	Remove
T10	White Pine	18	Poor	50% Dead	Yes	Remove
T11	White Pine	18	Poor		Yes	Remove
T12	White Pine	22	Poor		Yes	Remove
T13	White Pine	20	Poor		Yes	Remove
T14	White Pine	12	Dead		Yes	Remove
T15	White Pine	20	Poor	50% Dead	Yes	Remove
T16	European Beech	24	Fair	Large hole in trunk	Yes	Protect
T17	Littleread Linden	22	Fair	Overgrown with Ivy	Yes	Remove
T18	White Oak	36	Poor	Topped, Stump Growth	No	Remove
T19	Honeylocust	24	Fair	Inside Proposed Building	No	Remove
T20	Sugar Maple	14	Good		No	Protect
T21	Sugar Maple	18	Dead		No	Remove
T22	Sugar Maple	24	Fair		No	Protect
T23	Planerree	12	Good		No	Protect
T24	Planerree	12	Good		No	Protect
T25	Planerree	12	Good		No	Protect
T26	Planerree	14	Good		No	Protect
T27	Planerree	14	Good		No	Protect
T28	Red Oak	30	Good		No	Remove
T29	Red Oak	20	Dead		No	Remove
T30	Red Oak	36	Good		No	Remove
T31	Red Oak	24	Good		Yes	Protect
T32	Red Oak	24	Good		No	Remove
T33	Red Oak	24	Good		No	Remove
T34	Red Maple	4	Good		No	Transplant
T35	Red Maple	4	Good		No	Transplant
T36	Red Maple	4	Good		No	Transplant
T37	Red Maple	4	Good		No	Transplant
T38	Red Maple	4	Good		No	Transplant
T39	Red Maple	14	Good		No	Remove
T40	Sugar Maple	14	Dead		No	Remove
T41	Red Maple	14	Fair		No	Protect
T42	Red Maple	14	Fair		No	Protect







EXISTING TREE CALIPER TO BE REMOVED

Quantity of Trees	Size	Subtotal Caliper
2	14"	28"
3	18"	54"
2	20"	40"
3	22"	66"
4	24"	96"
1	26"	26"
2	30"	60"
2	36"	72"
Total Caliper: 442 inches of existing tree caliper removed		

PROPOSED TREE CALIPER

Quantity of Trees	Size	Subtotal Caliper
62	2.5" cal.	155" cal.
129	3.5" cal.	451" cal.
Total Caliper: 606 inches of tree caliper proposed		

TREE MITIGATION LEGEND

-  EXISTING DECIDUOUS TREE
-  EXISTING EVERGREEN TREE
-  TREE TO BE REMOVED
-  TREE TO BE PROTECTED
-  TREE TO BE TRANSPLANTED
-  PROPOSED 2.5" CALIPER TREE
-  PROPOSED 3.5" CALIPER TREE

TREE PROTECTION AND REMOVAL NOTES

- THIS SHEET DESCRIBES EXISTING TREE PRESERVATION AND REMOVAL WORK ONLY. REFER TO CIVIL ENGINEER'S DRAWINGS FOR COMPLETE SITE PREP AND DEMO REQUIREMENTS.
- TREE REMOVAL SCOPE SHALL INCLUDE THE FELLING, CUTTING, AND SATISFACTORY DISPOSAL OF ALL TREES, STUMPS AND VEGETATIVE DEBRIS PRODUCED THROUGH THE CLEARING OPERATIONS.
- FELL TREES IN SUCH A WAY AS TO NOT INJURE TREES TO BE SAVED. EXCAVATION OR GRADING WITHIN THE BRANCH SPREAD OF TREES TO BE SAVED SHALL BE PERFORMED ONLY UNDER THE DIRECTION OF THE OWNER'S REPRESENTATIVE UNLESS OTHERWISE DIRECTED.
- STUMPS TO BE REMOVED OUTSIDE THE TREE PRESERVATION AREA SHALL BE GRUBBED TO THEIR FULL DEPTH. ROOTS 3 INCHES AND LARGER SHALL BE REMOVED TO A DEPTH OF 2 FEET BELOW FINISHED GRADE. STUMPS SHALL BE LEGALLY DISPOSED OF OFF-SITE.
- STUMPS TO BE REMOVED WITHIN THE TREE PRESERVATION AREA SHALL BE GROUND DOWN USING A MECHANICAL STUMP GRINDER TO A DEPTH OF 2 FEET BELOW FINISHED GRADE.
- TREE PROTECTION FENCING SHALL BE INSTALLED AS SHOWN ON THIS PLAN AND REMAIN THROUGHOUT THE TIME OF CONSTRUCTION AS SPECIFIED AND DIRECTED BY THE OWNER'S REPRESENTATIVE.
- CONTRACTOR SHALL TAG ALL TREES TO BE REMOVED AND VERIFY WITH OWNER'S REPRESENTATIVE PRIOR TO THE START OF DEMOLITION.
- FOR ALL SITE PREP AND DEMO WORK OUTSIDE TREE PROTECTION AREA, SEE CIVIL ENGINEER'S DRAWINGS.
- NO STORAGE OF ANY TYPE OF MATERIAL, CHEMICAL OR EQUIPMENT SHALL BE ALLOWED IN THE PROTECTED FENCED IN AREA.
- BEFORE THE START OF ANY WORK ON THE SITE, PRECEDING THE ARRIVAL OF EQUIPMENT, MATERIALS OR VEHICLES TO THE SITE, AND PRIOR TO THE COMMENCEMENT OF ANY CLEARING ON THE SITE, THE CONTRACTOR SHALL ARRANGE A PRE-CONSTRUCTION CONFERENCE ON THE SITE WITH THE OWNER'S REPRESENTATIVE AND THE LANDSCAPE ARCHITECT TO IDENTIFY TREES AND SHRUBS THAT ARE TO BE PROTECTED OR REMOVED. DO NO CLEARING WITHOUT A CLEAR UNDERSTANDING OF EXISTING CONDITIONS TO BE PRESERVED. REFER TO SPECIFICATION SECTION 01 56 39 FOR MORE INFORMATION.
- REMOVE AND DISPOSE OF DEBRIS AS DIRECTED BY THE OWNER.
- ALL EXCAVATION WITHIN THE TREE PROTECTION ZONE TO BE DONE BY HAND TO MINIMIZE DISTURBANCE TO ROOT ZONES.
- FINAL LOCATION OF PROPOSED TRANSPLANTS TO BE COORDINATED WITH TOWN AND OWNERSHIP.

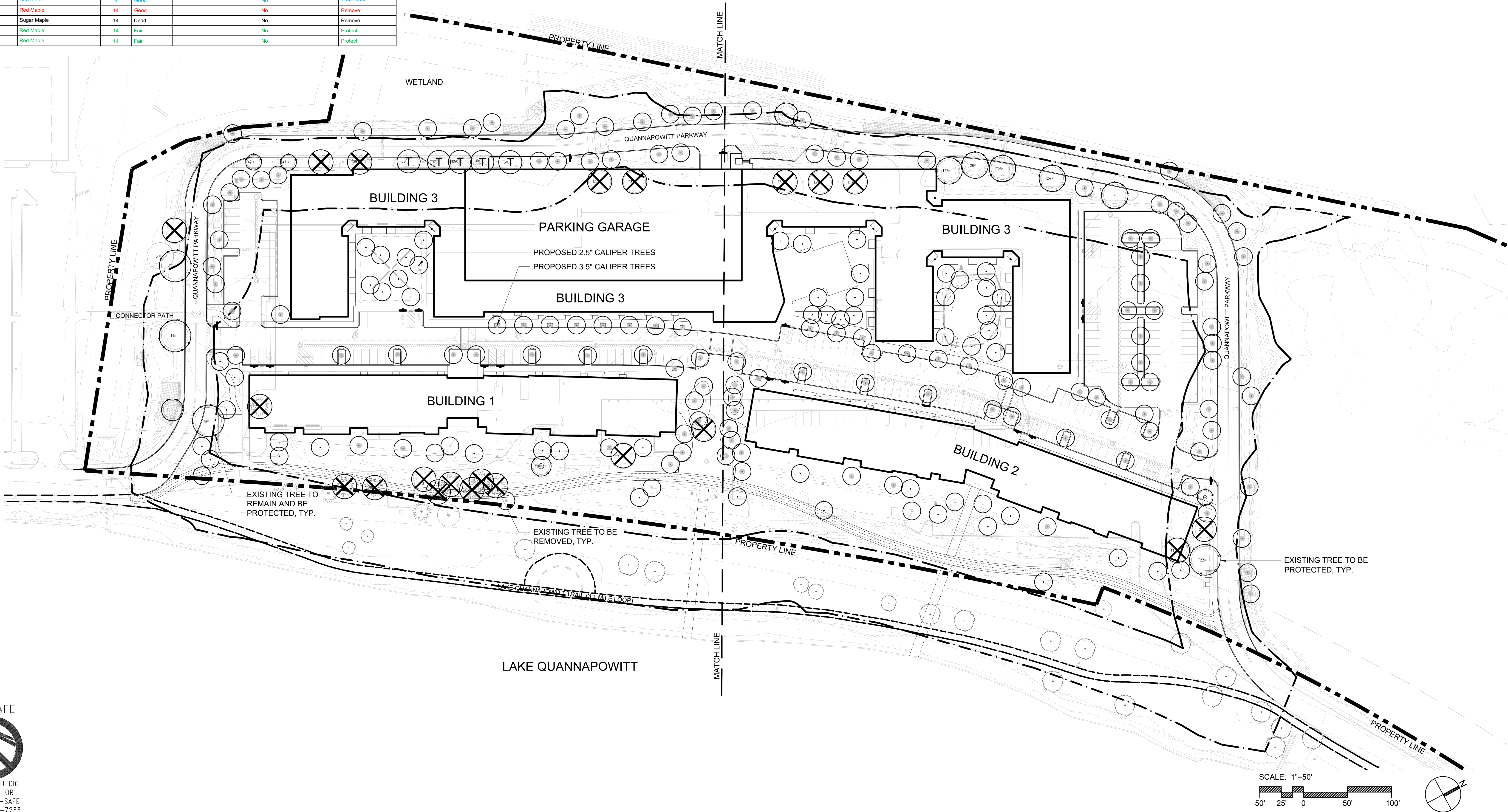

2	8/03/2021	NOI SUBMISSION
1	3/31/2021	SPECIAL PERMIT SUBMISSION
REV	DATE	DESCRIPTION

APPLICANT/OWNER:  
CABOT, CABOT & FORBES  
185 DARTMOUTH STREET  
BOSTON, MA 02116

PROJECT:  
200 QUANNAPOWITT  
PARKWAY  
WAKEFIELD, MA 01880

PROJECT NO. 2021	DATE: 3/16/2021
SCALE: 1" = 10'-0"	DWG. NAME: 200QP.dwg
DESIGNED BY: AD IJR	CHECKED BY: IJR

PREPARED BY:

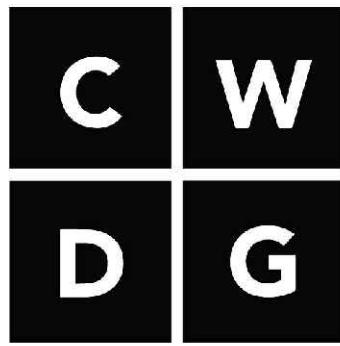

Copley Wolff Design Group  
Landscape Architects & Planners

THIS DRAWING HAS BEEN PREPARED IN DIGITAL FORMAT. CLIENT/CUSTOMER'S REPRESENTATIVE OR CONSULTANTS MAY BE PROVIDED COPIES OF DRAWINGS AND SPECIFICATIONS FOR HIGHER INFORMATION AND/OR SPECIFIC USE ON THIS PROJECT. DUE TO THE POTENTIAL THAT THE PROVIDED INFORMATION MAY BE MODIFIED UNINTENTIONALLY OR OTHERWISE, ALLEN & MAJOR ASSOCIATES, INC. MAY REMOVE ALL INDICATION OF THE DOCUMENT'S AUTHORITYSHIP ON THE DIGITAL MEDIA. PRINTED REPRESENTATIONS OR PORTABLE DOCUMENT FORMAT OF THE DRAWINGS AND SPECIFICATIONS ISSUED SHALL BE THE ONLY RECORD COPIES OF ALLEN & MAJOR ASSOCIATES, INC.'S WORK PRODUCT.

DRAWING TITLE: Tree Mitigation Plan	SHEET No. L-000
--	--------------------

Copyright © 2021 Allen & Major Associates, Inc.  
All Rights Reserved

DIG SAFE



BEFORE YOU DIG  
CALL 811 OR  
1-888-DIG-SAFE  
1-888-344-7233

T:\2021 200 QUANNAPOWITT PARKWAY\WAKEFIELD W. CUBES-COT CONSTRUCTION DRAWINGS\CURRENT CNDG DRAWINGS\200QP-SITE PLAN.DWG



LANDSCAPE GENERAL NOTES

1. THE SITE PLAN IS BASED ON EXISTING CONDITIONS INFORMATION PROVIDED BY OTHERS. COPLEY-WOLFF DESIGN GROUP IS NOT RESPONSIBLE FOR THE ACCURACY OR COMPLETENESS OF THIS INFORMATION.
2. CONSULT ALL DRAWINGS AND SPECIFICATIONS FOR COORDINATION REQUIREMENTS BETWEEN ALL TRADES BEFORE COMMENCING NEW CONSTRUCTION. CONTRACTOR SHALL NOTIFY OWNERS REPRESENTATIVE IMMEDIATELY OF ANY AND ALL CONFLICTS BETWEEN PROPOSED SITE WORK AND WORK OF ALL OTHER TRADES.
3. CONTRACTOR SHALL VERIFY ALL CONDITIONS IN THE FIELD AND REPORT ANY DISCREPANCIES TO THE OWNER'S REPRESENTATIVE PRIOR TO COMMENCING WORK. ANY ALTERATIONS TO THESE DRAWINGS MADE IN THE FIELD SHALL BE PROMPTLY REPORTED BY THE CONTRACTOR TO THE OWNER'S REPRESENTATIVE FOR REVIEW AND APPROVAL AND RECORDED ON RECORD DRAWINGS.
4. CONTRACTOR SHALL BE RESPONSIBLE FOR REPAIRING DAMAGE INSIDE AND OUTSIDE THE LIMIT OF WORK LINE DUE TO CONTRACT OPERATIONS.
5. CONTRACTOR SHALL RESTORE DAMAGED AREAS BEYOND CONTRACT LIMITS TO THEIR ORIGINAL CONDITION AT NO ADDITIONAL COST TO THE OWNER.
6. LOCATION OF EXISTING ABOVEGROUND AND UNDERGROUND UTILITIES SHOWN ON THIS PLAN ARE DIAGRAMMATIC ONLY AND DO NOT REPRESENT ACCURATE LOCATIONS. THE CONTRACTOR SHALL CONTACT LOCAL UTILITY COMPANIES, AND DIG-SAFE TO CONFIRM THE LOCATIONS OF ALL EXISTING UTILITIES BEFORE COMMENCING WORK. ANY DAMAGE DUE TO THE FAILURE OF THE CONTRACTOR TO CONTACT AUTHORITIES SHALL BE BORN BY THE CONTRACTOR. THE CONTRACTOR SHALL REPAIR ANY DAMAGE INCURRED DURING CONSTRUCTION TO EXISTING UTILITIES SCHEDULED TO REMAIN AT NO COST TO THE OWNER.
7. WHERE NEW PAVING MEETS EXISTING PAVING, MEET LINE AND GRADE OF EXISTING SMOOTHLY WITH NEW CONSTRUCTION.
8. CONTRACTOR SHALL COMPLY WITH ALL REQUIREMENTS OF PERMITS AND LICENSEES ISSUED BY THE FEDERAL, STATE AND LOCAL AGENCIES (SEE SPECS).
9. CONTRACTOR SHALL COORDINATE ALL SITE UTILITY IMPROVEMENTS WITH THE PROPER AUTHORITIES.

PLANTING SCHEDULE - INFILTRATION BASIN

INFILTRATION BASINS TO BE PLANTED AS FOLLOWS.

SUPPLIER: NEW ENGLAND WETLAND PLANTS, INC.  
TYPE: NEW ENGLAND WETMIX  
SEED MIX DETAILS: CAREX VULPINOIDEA, CAREX SCOPARIA, CAREX LURIDA, CAREX LUPULINA, POA PALUSTRIS, BIDENS FRONDOSA, SCIRPUS ATROVIRENS, ASCLEPIAS INCARNATA, CAREX CRINITA, VERONIA NOVEBORACENSIS, JUNCUS EFFUSUS, ASTER LATERIFLORUS, IRIS VERSICOLOR, GLYCERIA GRANDIS, MUMULUS RINGENS, EUPATORIUM MACULATUM

TOTAL SQUARE FOOTAGE OF SEED MIX: 26,459 SF

PLANTING SCHEDULE - GENERAL SITE

Symbol	Qty.	Scientific Name	Common Name	Size	Comments
<b>Deciduous Trees</b>					
AR	12	<i>Acer rubrum</i>	Red Maple	3" - 3 1/2" cal.	B&B, Matched
CK	11	<i>Cladrasis kentuckea</i>	Yellowwood	2 1/2" - 3" cal.	B&B, Matched
CO	11	<i>Celtis occidentalis</i>	Hackberry	3" - 3 1/2" cal.	B&B, Matched
QI	11	<i>Quercus macrocarpa</i>	Bur Oak	3" - 3 1/2" cal.	B&B, Matched
QP	11	<i>Quercus palustris</i>	Pin Oak	3" - 3 1/2" cal.	B&B, Matched
<b>Ornamental Trees</b>					
CM	19	<i>Crataegus laevigata</i> 'Crimson Cloud'	Crimson Cloud Hawthorn	1 1/2" - 2" cal.	B&B, Matched
CV	19	<i>Chionanthus virginicus</i>	Fringetree	8'-10' ht.	B&B, Matched
HV	19	<i>Hamamelis virginiana</i>	Witchhazel	5'-6' ht.	B&B, Matched
<b>Shrubs</b>					
AM	204	<i>Aronia melanocarpa</i>	Black Chokecherry	36"-42" ht.	36" O.C. spacing
CA	204	<i>Clethra alniolia</i>	Sweet Pepperbush	36"-42" ht.	36" O.C. spacing
CO	204	<i>Ceanothus americanus</i>	New Jersey Tea	30"-36" ht.	36" O.C. spacing
FG	204	<i>Fothergilla gardenii</i> 'Suzanne'	Dwarf Fothergilla	30"-36" ht.	36" O.C. spacing
HQ	204	<i>Hydrangea quercifolia</i>	Oakleaf Hydrangea	30"-36" ht.	36" O.C. spacing
IVW	204	<i>Ilex verticillata</i> 'Winter Red'	Winter Red Winterberry	42"-48" ht.	B&B, 48" O.C. spacing
IVS	204	<i>Ilex verticillata</i> 'Southern Gentleman'	Southern Gentleman Winterberry	42"-48" ht.	B&B, 48" O.C. spacing
IVH	204	<i>Itea virginica</i> 'Henry's Garnet'	Dwarf Sweetspire	30"-36" ht.	24" O.C. spacing
MP	204	<i>Myrica pennsylvanica</i>	Bayberry	42"-48" ht.	B&B, 48" O.C. spacing
ST	204	<i>Spiraea tomentosa</i>	Steeplebush	30"-36" ht.	36" O.C. spacing
SA	204	<i>Symphoricarpos albus</i>	Snowberry	30"-36" ht.	36" O.C. spacing
VNW	204	<i>Viburnum nudum</i> 'Winterthur'	Smooth Witherod	3'-4' ht.	B&B, 6' O.C. spacing
<b>Perennials / Grasses / Groundcovers</b>					
AN					
CL	548	<i>Coreopsis lanceolata</i>	Lanceleaf Coreopsis	2 GAL.	24" O.C. spacing
DC	548	<i>Deschampsia cespitosa</i>	Tufted Hair Grass	2 GAL.	12" O.C. spacing
HS	548	<i>Helictotrichon sempervirens</i> 'Saphirsprudel'	Blue Oat Grass	2 GAL.	24" O.C. spacing
LN	548	<i>Liastris novae-angliae</i>	New England Blazing Star	2 GAL.	12" O.C. spacing
NF	548	<i>Nepeta faassenii</i>	Catmint	2 GAL.	18" O.C. spacing
PFG	548	<i>Potentilla fruticosa</i> 'Goldfinger'	Shrubby Cinquefoil	2 GAL.	24" O.C. spacing
PV	548	<i>Panicum virgatum</i>	Switchgrass	2 GAL.	18" O.C. spacing
RA	548	<i>Rhus aromatica</i> 'Gro-low'	Gro-low Sumac	2 GAL.	36" O.C. spacing
SH	548	<i>Sporobolus heterolepis</i> 'Tara'	Prairie Dropseed	2 GAL.	24" O.C. spacing
TD	548	<i>Tripsacum dactyloides</i>	Eastern Gama Grass	2 GAL.	24" O.C. spacing
WF	548	<i>Waldsteinia fragaroides</i>	Barren Strawberry	2 GAL.	12" O.C. spacing

PLANTING SCHEDULE - RAIN GARDEN

Symbol	Qty.	Scientific Name	Common Name	Size	Comments
<b>Deciduous Trees</b>					
BA	13	<i>Betula alleghaniensis</i>	Yellow Birch	10'-12' ht.	B&B, Matched
LL	13	<i>Larix laricina</i>	Eastern Larch	10'-12' ht.	B&B, Matched
NS	13	<i>Nyssa sylvatica</i>	Tupelo	2 1/2"-3" cal.	B&B, Matched
<b>Ornamental Trees</b>					
BN	8	<i>Betula nigra</i>	River Birch	8'-10' ht.	B&B, Matched
CC	7	<i>Carpinus caroliniana</i>	American Hornbeam	10'-12' ht.	B&B, Matched
JV	7	<i>Juniperus virginiana</i>	Eastern Red Cedar	8'-10' ht.	B&B, Matched
HV	7	<i>Hamamelis virginiana</i>	Witchhazel	5'-6' ht.	B&B, Matched
RT	7	<i>Rhus typhina</i>	Staghorn Sumac	5'-6' ht.	B&B, Matched
<b>Shrubs</b>					
AN	109	<i>Alnus incana</i>	Speckled Alder	36"-42" ht.	36" O.C. spacing
CA	109	<i>Clethra alniolia</i>	Sweet Pepperbush	36"-42" ht.	36" O.C. spacing
CO	109	<i>Cephalanthus occidentalis</i>	Buttonbush	30"-36" ht.	36" O.C. spacing
CR	109	<i>Cornus racemosa</i>	Grey Dogwood	30"-36" ht.	36" O.C. spacing
LB	109	<i>Lindera benzoin</i>	Common Spicebush	30"-36" ht.	36" O.C. spacing
IVW	109	<i>Ilex verticillata</i> 'Winter Red'	Winter Red Winterberry	42"-48" ht.	B&B, 48" O.C. spacing
IVS	109	<i>Ilex verticillata</i> 'Southern Gentleman'	Southern Gentleman Winterberry	42"-48" ht.	B&B, 48" O.C. spacing
IVH	109	<i>Itea virginica</i> 'Henry's Garnet'	Dwarf Sweetspire	30"-36" ht.	24" O.C. spacing
MP	109	<i>Myrica pennsylvanica</i>	Bayberry	42"-48" ht.	B&B, 48" O.C. spacing
RV	109	<i>Rhododendron viscosum</i>	Swamp Azalea	30"-36" ht.	36" O.C. spacing
SC	109	<i>Sambucus canadensis</i>	Elderberry	30"-36" ht.	36" O.C. spacing
ST	109	<i>Spiraea tomentosa</i>	Steeplebush	30"-36" ht.	36" O.C. spacing
VN	109	<i>Viburnum nudum</i>	Wild Raisin	42"-48" ht.	B&B, 48" O.C. spacing
<b>Perennials / Grasses / Groundcovers</b>					
AI	272	<i>Asclepias incarnata</i>	Swamp Milkweed	2 GAL.	24" O.C. spacing
AP	272	<i>Aster puniceus</i>	Swamp Aster	2 GAL.	24" O.C. spacing
AN	272	<i>Aster novae-angliae</i>	New England Aster	2 GAL.	18" O.C. spacing
CC	272	<i>Carex comosa</i>	Bearded Sedge	2 GAL.	12" O.C. spacing
CS	272	<i>Carex stricta</i>	Tussock Sedge	2 GAL.	12" O.C. spacing
EM	272	<i>Eupatorium maculatum</i>	Spotted Joe Pye Weed	2 GAL.	36" O.C. spacing
IVR	272	<i>Iris versicolor</i>	Northern Blue Flag Iris	2 GAL.	24" O.C. spacing
HM	272	<i>Hibiscus moscheutos</i>	Crimsoneyed Rosemallow	2 GAL.	24" O.C. spacing
LN	272	<i>Liastris novae-angliae</i>	New England Blazing Star	2 GAL.	12" O.C. spacing
LC	272	<i>Lobelia cardinalis</i>	Cardinal Flower	2 GAL.	18" O.C. spacing
SD	272	<i>Salix discolor</i>	Pussy Willow	2 GAL.	24" O.C. spacing
SS	272	<i>Schizachyrium scoparium</i>	Little Bluestem	2 GAL.	18" O.C. spacing
TA	272	<i>Typhus angustifolia</i>	Narrowleaf Cattail	2 GAL.	12" O.C. spacing
VA	272	<i>Vaccinium angustifolium</i>	Lowbush Blueberry	2 GAL.	12" O.C. spacing

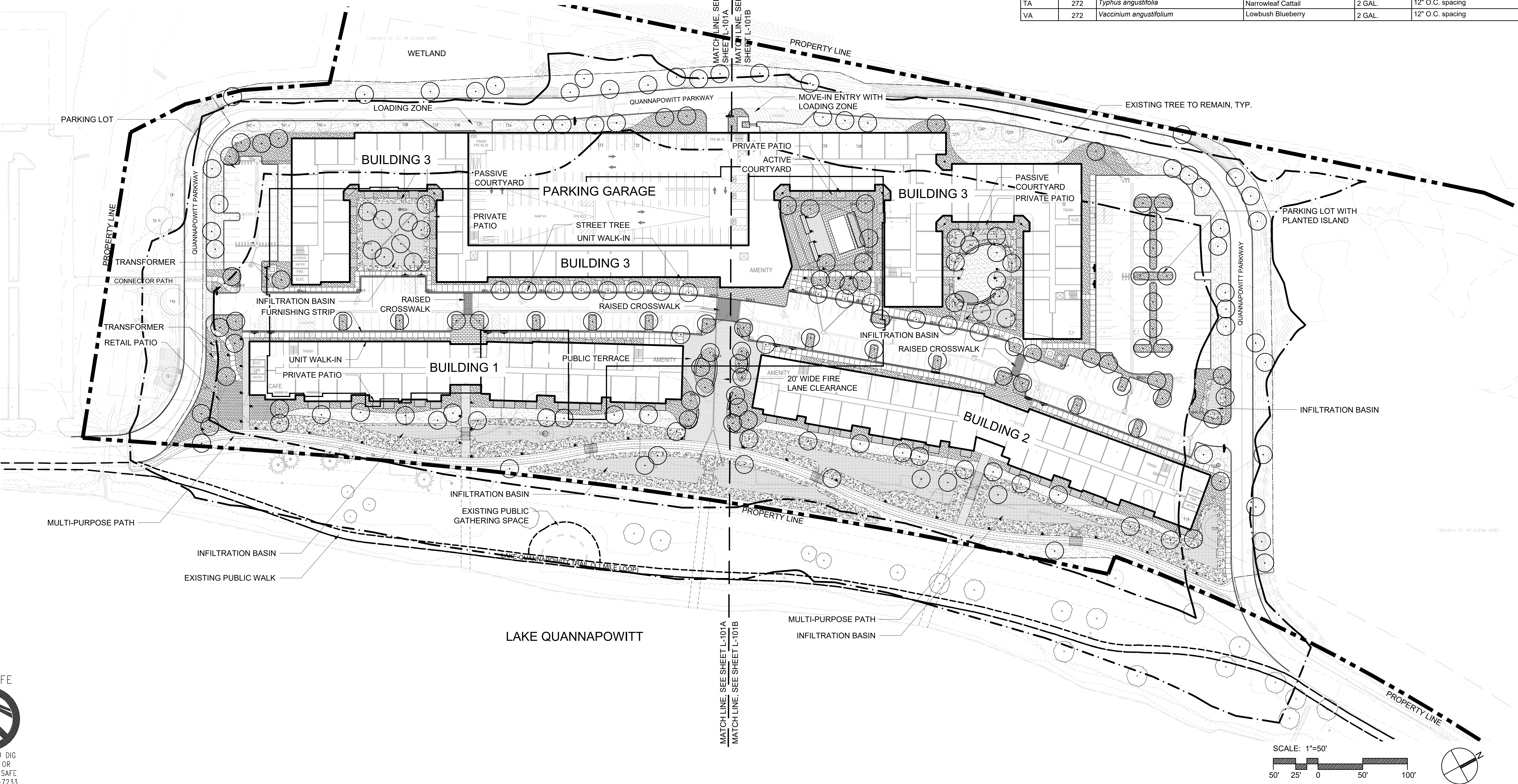

2	8/03/2021	NOI SUBMISSION
1	3/31/2021	SPECIAL PERMIT SUBMISSION
REV	DATE	DESCRIPTION

APPLICANT/OWNER:  
CABOT, CABOT & FORBES  
185 DARTMOUTH STREET  
BOSTON, MA 02116

PROJECT:  
200 QUANNAPOWITT  
PARKWAY  
WAKEFIELD, MA 01880

PROJECT NO. 2021	DATE: 3/16/2021
SCALE: 1" = 10'-0"	DWG. NAME: 200QP.dwg
DESIGNED BY: AD IIR	CHECKED BY: IIR



Copley Wolff Design Group  
Landscape Architects & Planners

THIS DRAWING HAS BEEN PREPARED IN DIGITAL FORMAT. CLIENT/CUSTOMER'S REPRESENTATIVE OR CONSULTANTS MAY BE PROVIDED COPIES OF DRAWINGS AND SPECIFICATIONS FOR HIGHER INFORMATION AND/OR SPECIFIC USE ON THIS PROJECT. DUE TO THE POTENTIAL THAT THE PROVIDED INFORMATION MAY BE MODIFIED UNINTENTIONALLY OR OTHERWISE, ALLEN & MAJOR ASSOCIATES, INC. MAY REMOVE ALL INDICATION OF THE DOCUMENT'S AUTHORITY ON THE DIGITAL MEDIA. PRINTED REPRESENTATIONS OR PORTABLE DOCUMENT FORMAT OF THE DRAWINGS AND SPECIFICATIONS ISSUED SHALL BE THE ONLY RECORD COPIES OF ALLEN & MAJOR ASSOCIATES, INC.'S WORK PRODUCT.

DRAWING TITLE: Overall Plan	SHEET No. L-100
--------------------------------	--------------------



T:\2021 200 QUANNAPOWITT PARKWAY\WETFIELD W. CUBES-COT CONSTRUCTION DRAWINGS\CURRENT CNDG DRAWINGS\200QP-SITE PLAN.DWG



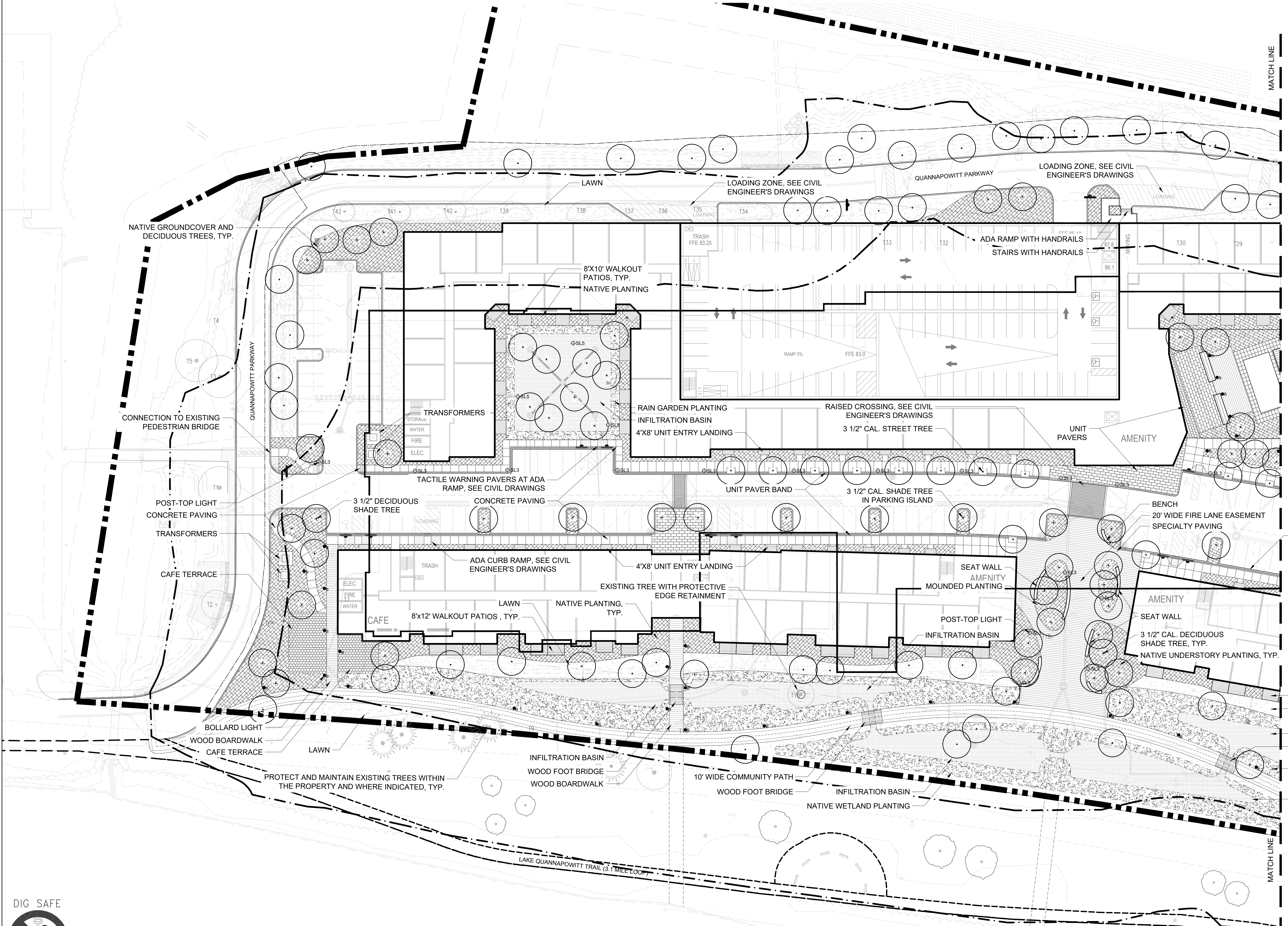

MATERIAL LEGEND

- CONCRETE PAVING
- WOOD DECKING
- FURNISHING STRIP
- CONCRETE UNIT PAVERS
- STONE MAINTENANCE PATH
- LAWN
- INFILTRATION BASIN
- RAIN GARDEN PLANTING
- STANDARD PLANTING
- POOL
- POOL FENCE
- POST-TOP LIGHT
- BOLLARD LIGHT
- WOOD BRIDGE
- SEAT WALL
- EDGE RETAINMENT AT EXISTING TREES



2	8/03/2021	NOI SUBMISSION
1	3/31/2021	SPECIAL PERMIT SUBMISSION
REV	DATE	DESCRIPTION

APPLICANT/OWNER:  
CABOT, CABOT & FORBES  
185 DARTMOUTH STREET  
BOSTON, MA 02116

PROJECT:  
200 QUANNAPOWITT  
PARKWAY  
WAKEFIELD, MA 01880

PROJECT NO. 2021	DATE: 3/16/2021
SCALE: 1" = 10'-0"	DWG. NAME: 200QP.dwg
DESIGNED BY: AD IJR	CHECKED BY: IJR



Copley Wolff Design Group  
Landscape Architects & Planners

THIS DRAWING HAS BEEN PREPARED IN DIGITAL FORMAT. CLIENTS' REPRESENTATIVE OR CONSULTANTS MAY BE PROVIDED COPIES OF DRAWINGS AND SPECIFICATIONS FOR HIGHER INFORMATION AND/OR SPECIFIC USE ON THIS PROJECT. DUE TO THE POTENTIAL THAT THE PROVIDED INFORMATION MAY BE MODIFIED UNINTENTIONALLY OR OTHERWISE, ALLEN & MAJOR ASSOCIATES, INC. MAY REMOVE ALL INDICATION OF THE DOCUMENT'S AUTHORSHIP ON THE DIGITAL MEDIA. PRINTED REPRESENTATIONS OR PORTABLE DOCUMENT FORMAT OF THE DRAWINGS AND SPECIFICATIONS ISSUED SHALL BE THE ONLY RECORD COPIES OF ALLEN & MAJOR ASSOCIATES, INC.'S WORK PRODUCT.

DRAWING TITLE: Landscape Plan	SHEET No. L-101A
----------------------------------	---------------------

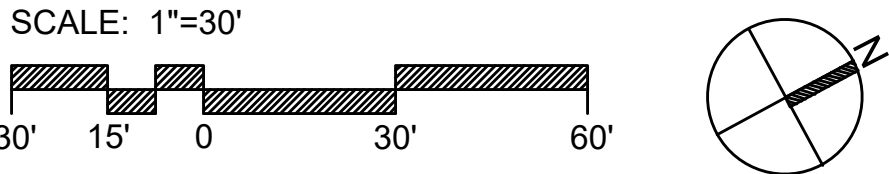

T:\2021 200 QUANNAPOWITT PARKWAY\WAKEFIELD MA\01880-CONSTRUCTION DRAWINGS\CURRENT CDDG DRAWINGS\200QP SITE PLAN.DWG



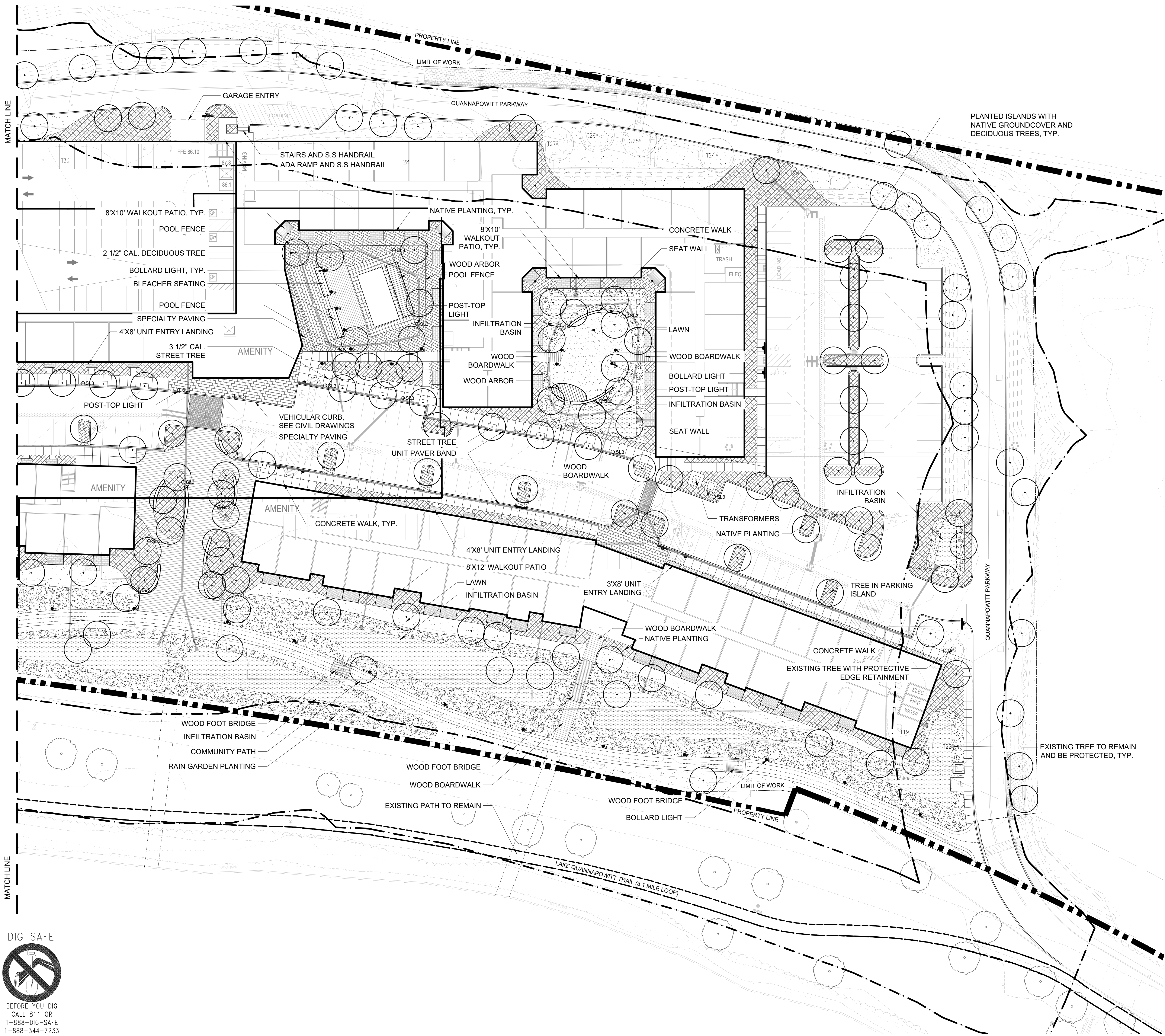

MATERIAL LEGEND

- CONCRETE PAVING
- WOOD DECKING
- FURNISHING STRIP
- CONCRETE UNIT PAVERS
- STONE MAINTENANCE PATH
- LAWN
- INFILTRATION BASIN
- RAIN GARDEN PLANTING
- STANDARD PLANTING
- POOL
- POOL FENCE
- POST-TOP LIGHT
- BOLLARD LIGHT
- WOOD BRIDGE
- SEAT WALL
- EDGE RETAINMENT AT EXISTING TREES



2	8/03/2021	NOI SUBMISSION
1	3/31/2021	SPECIAL PERMIT SUBMISSION
REV	DATE	DESCRIPTION

APPLICANT/OWNER:  
CABOT, CABOT & FORBES  
185 DARTMOUTH STREET  
BOSTON, MA 02116

PROJECT:  
200 QUANNAPOWITT  
PARKWAY  
WAKEFIELD, MA 01880

PROJECT NO. 2021	DATE: 3/16/2021
SCALE: 1" = 10'-0"	DWG. NAME: 200QP.dwg
DESIGNED BY: AD IJR	CHECKED BY: IJR

PREPARED BY:

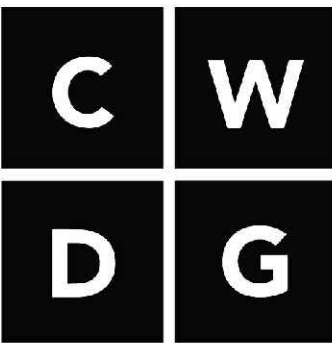

Copley Wolff Design Group  
Landscape Architects & Planners

THIS DRAWING HAS BEEN PREPARED IN DIGITAL FORMAT. CLIENT/CUSTOMER'S REPRESENTATIVE OR CONSULTANTS MAY BE PROVIDED COPIES OF DRAWINGS AND SPECIFICATIONS FOR HIGHER INFORMATION AND/OR SPECIFIC USE ON THIS PROJECT. DUE TO THE POTENTIAL THAT THE PROVIDED INFORMATION MAY BE MODIFIED UNINTENTIONALLY OR OTHERWISE, ALLEN & MAJOR ASSOCIATES, INC. MAY REMOVE ALL INDICATION OF THE DOCUMENT'S AUTHORSHIP ON THE DIGITAL MEDIA. PRINTED REPRESENTATIONS OR PORTABLE DOCUMENT FORMAT OF THE DRAWINGS AND SPECIFICATIONS ISSUED SHALL BE THE ONLY RECORD COPIES OF ALLEN & MAJOR ASSOCIATES, INC.'S WORK PRODUCT.

DRAWING TITLE: LANDSCAPE PLAN	SHEET No. L-101B
----------------------------------	---------------------

Copyright © 2020 Allen & Major Associates, Inc.  
All Rights Reserved

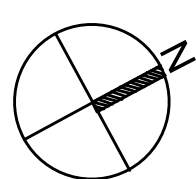
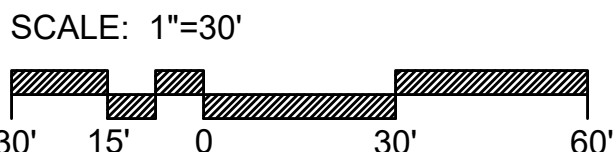

T:\2021 200 QUANNAPOWITT PARKWAY\WAKEFIELD W. CUBES-CO7 CONSTRUCTION DRAWINGS\CURRENT\CMO DRAWINGS\200QP SITE PLAN.DWG



- NOTE:  
1. CONTROL JOINTS EVERY 5' UNLESS OTHERWISE SHOWN ON PLAN.  
2. PROVIDE EXPANSION JOINT EVERY 20' UNLESS OTHERWISE SHOWN ON PLAN.  
3. PROVIDE EXPANSION JOINT WITH SEALANT WHERE CONCRETE PAVEMENT ABUTS CURBS, WALLS, AND BUILDING FACES.  
4. PROVIDE 10" DEEP THICKENED EDGE AT PLANTING BEDS, 6" WIDTH.

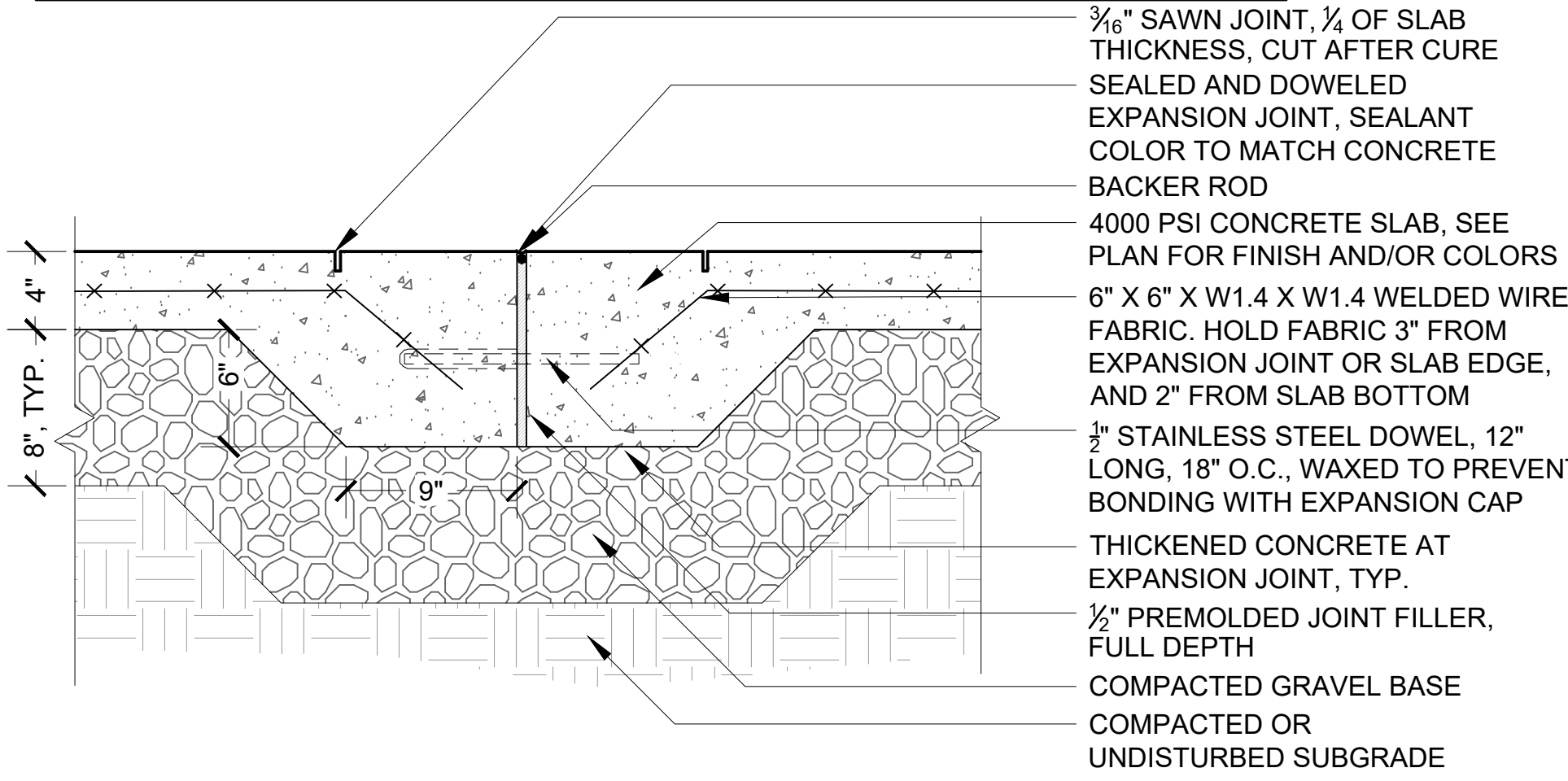

1 PEDESTRIAN CONCRETE PAVING  
1 1/2" = 1'-0"

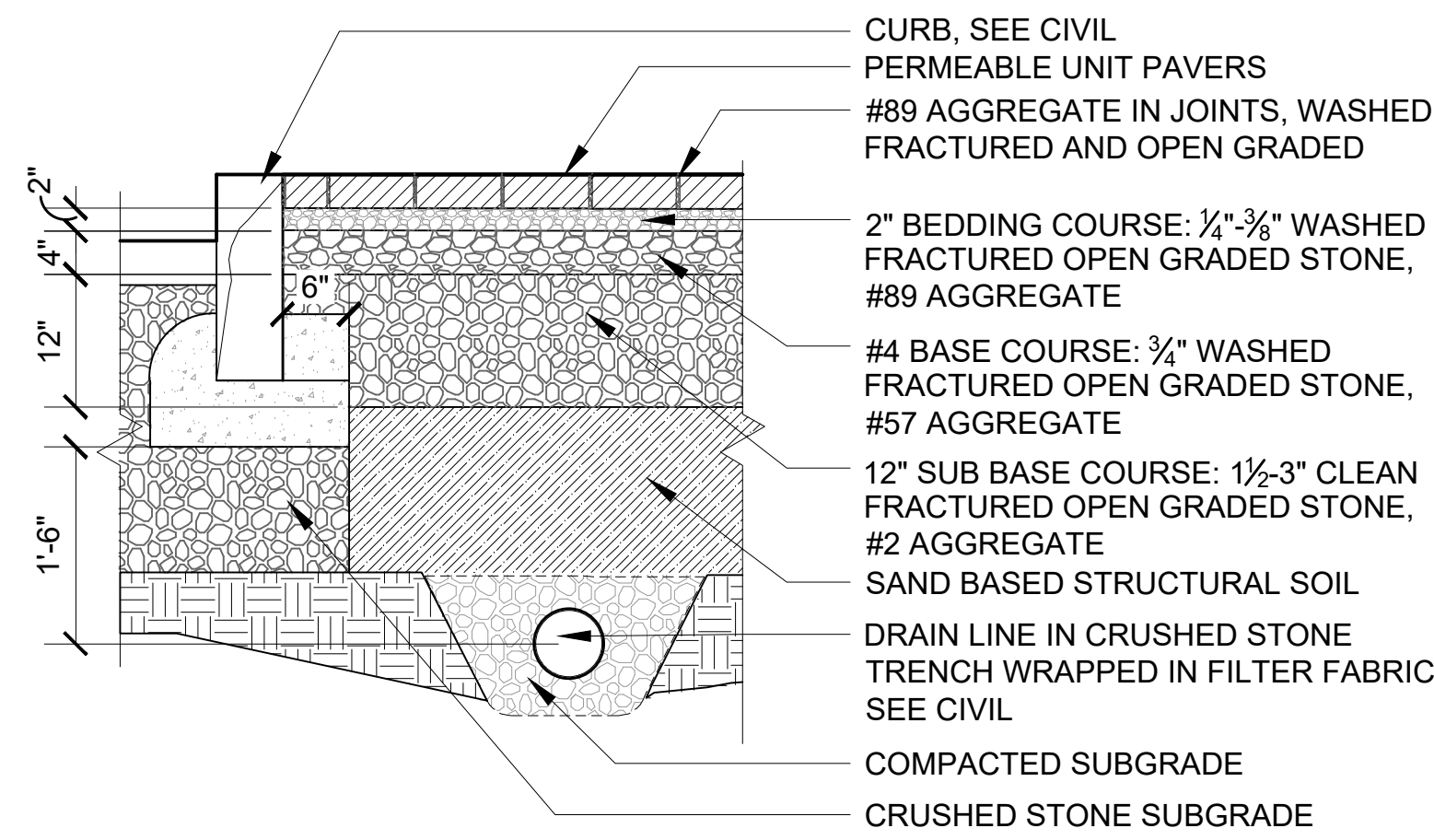

2 PEDESTRIAN PERMEABLE PAVING  
3/4" = 1'-0"

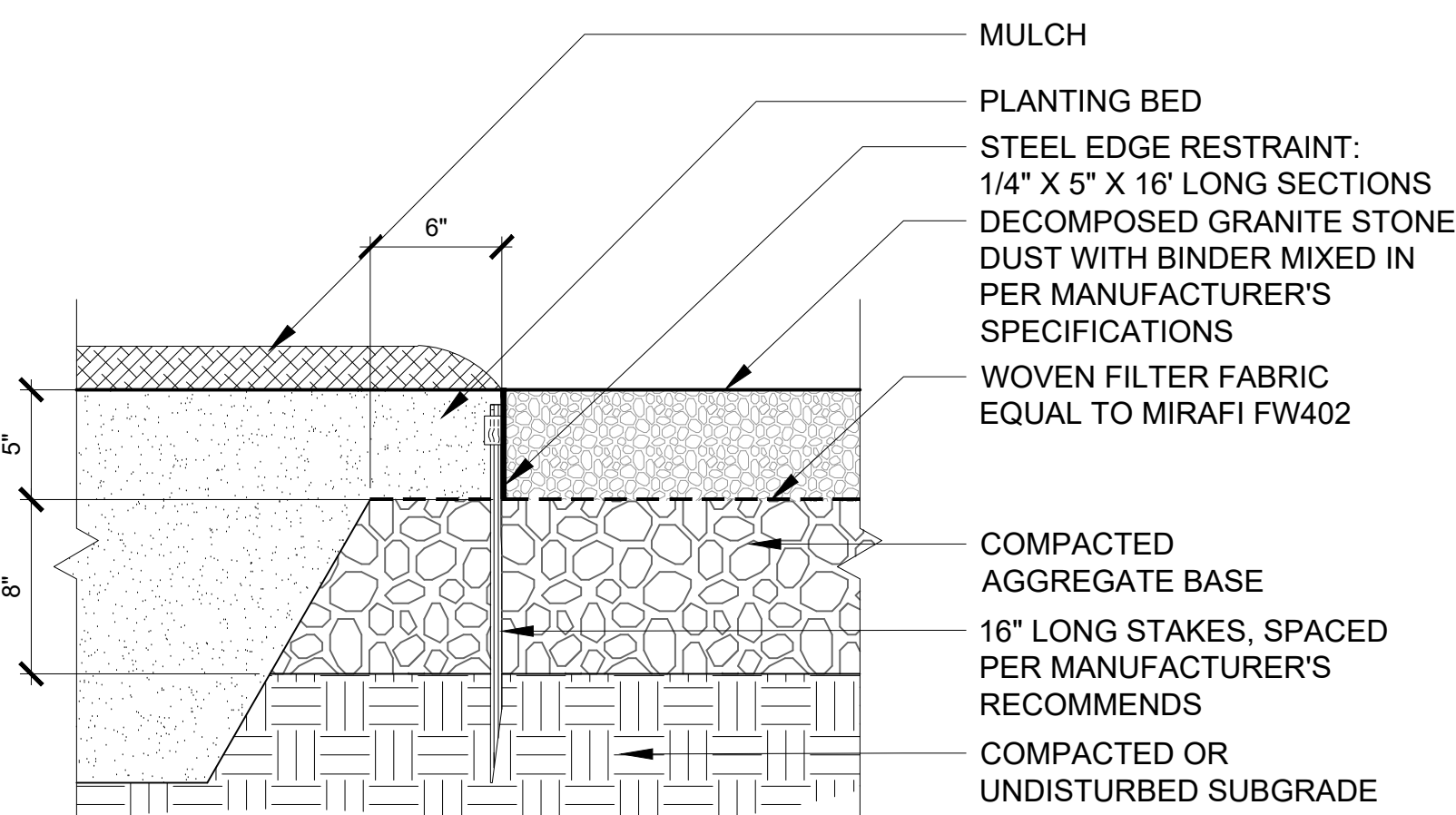

3 STONEDUST PAVING  
1 1/2" = 1'-0"

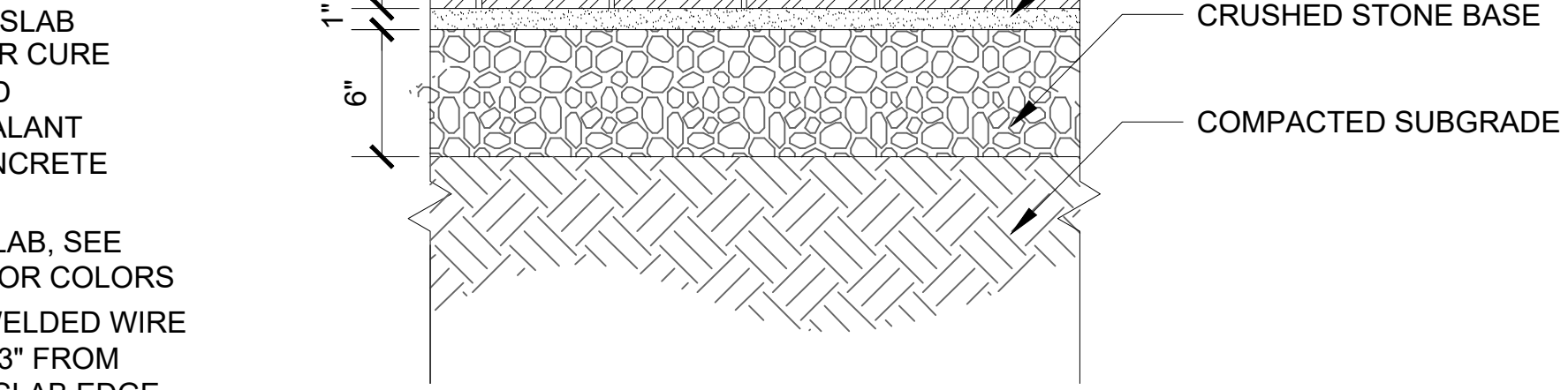

5 PEDESTRIAN UNIT PAVING  
1 1/2" = 1'-0"

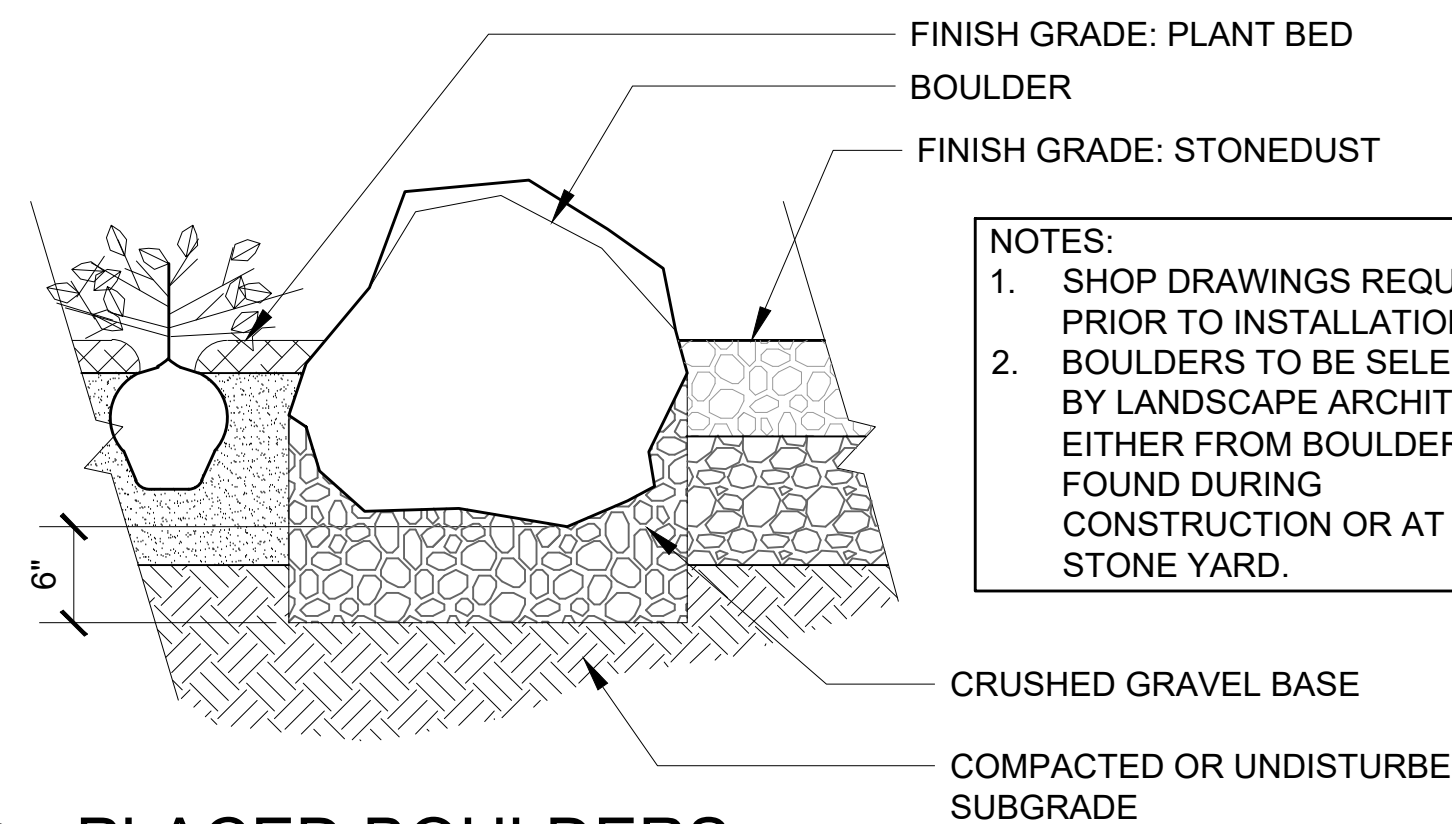

6 PLACED BOULDERS  
1" = 1'-0"

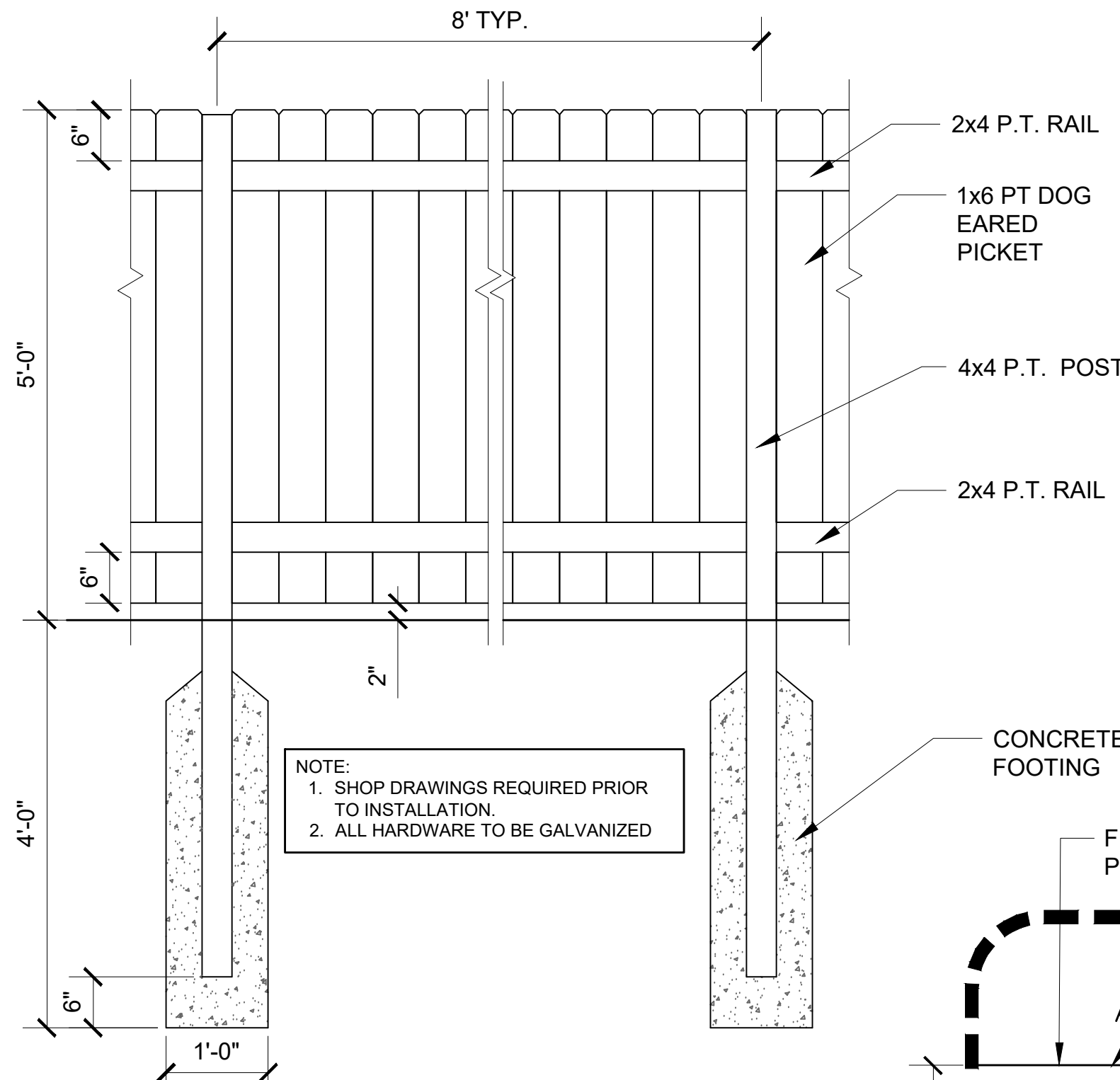

7 WOOD SCREEN FENCE  
3/4" = 1'-0"

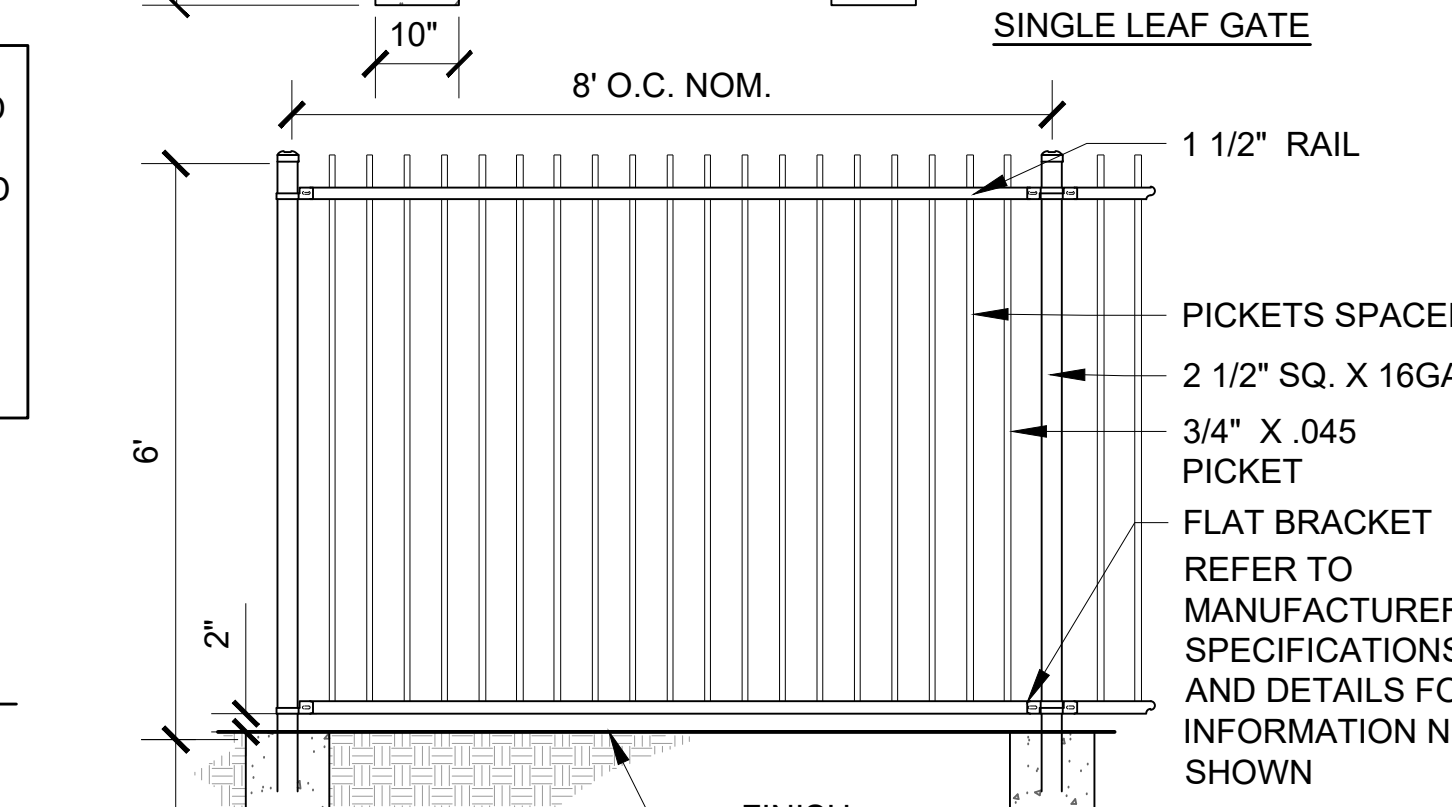
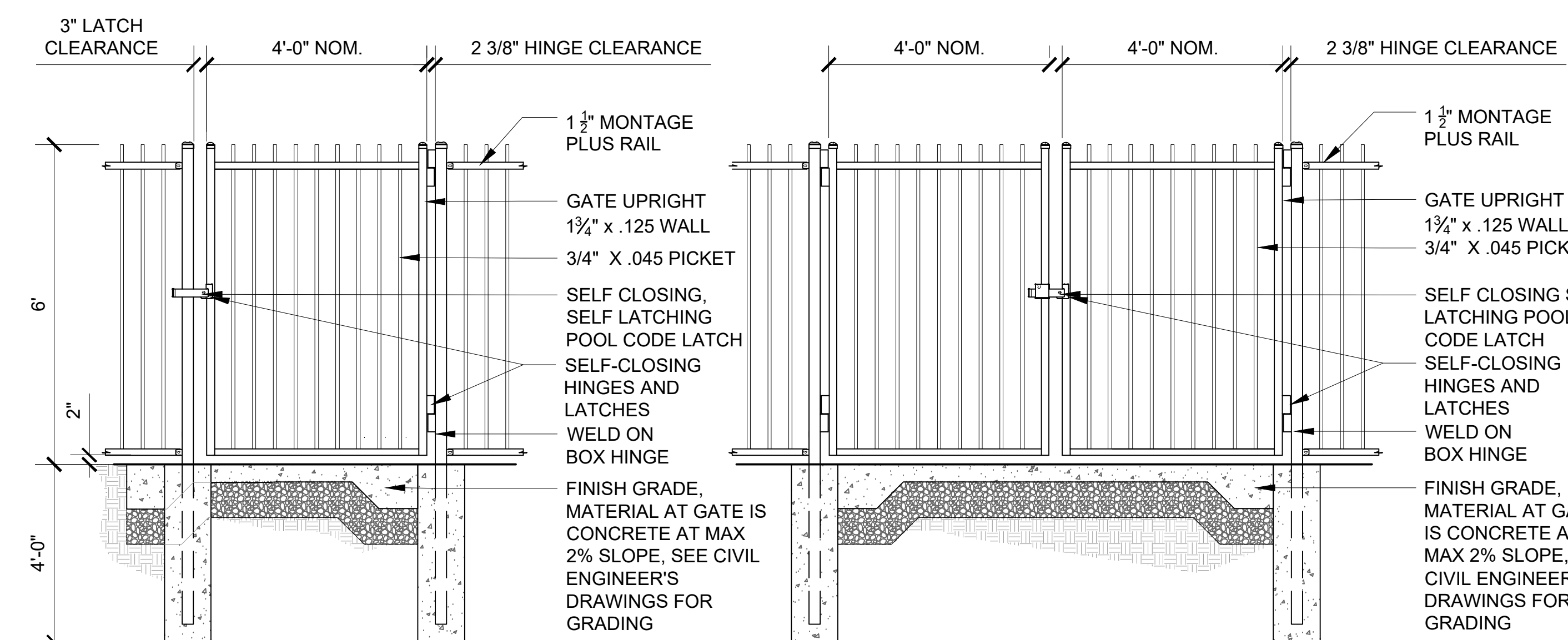

8 POOL FENCE  
1/2" = 1'-0"

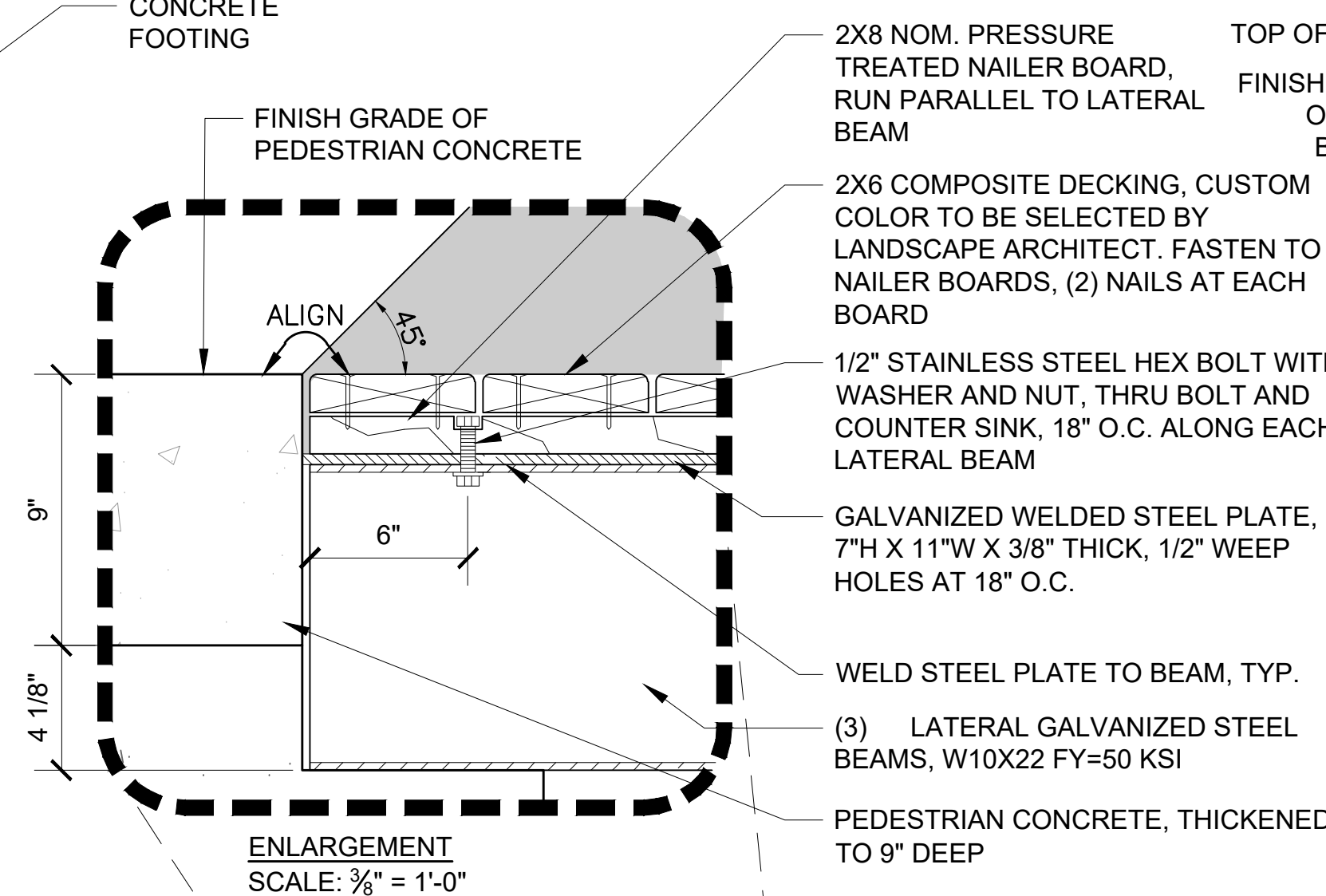

ENLARGEMENT  
SCALE: 3/8" = 1'-0"

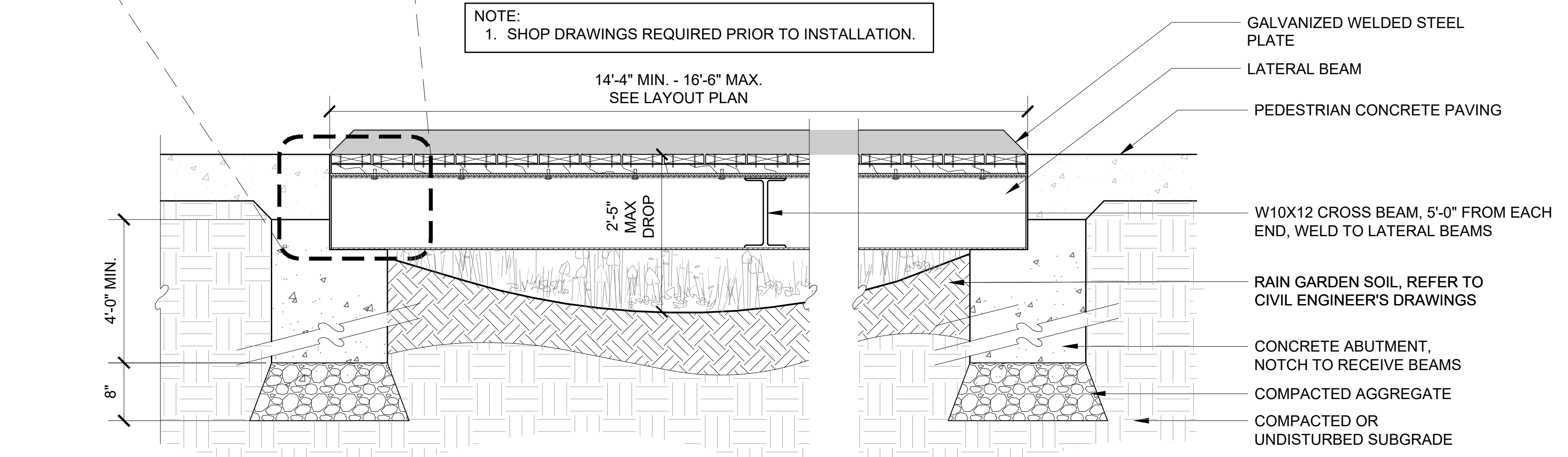

9 BRIDGE AT RAIN GARDEN  
1" = 1'-0"

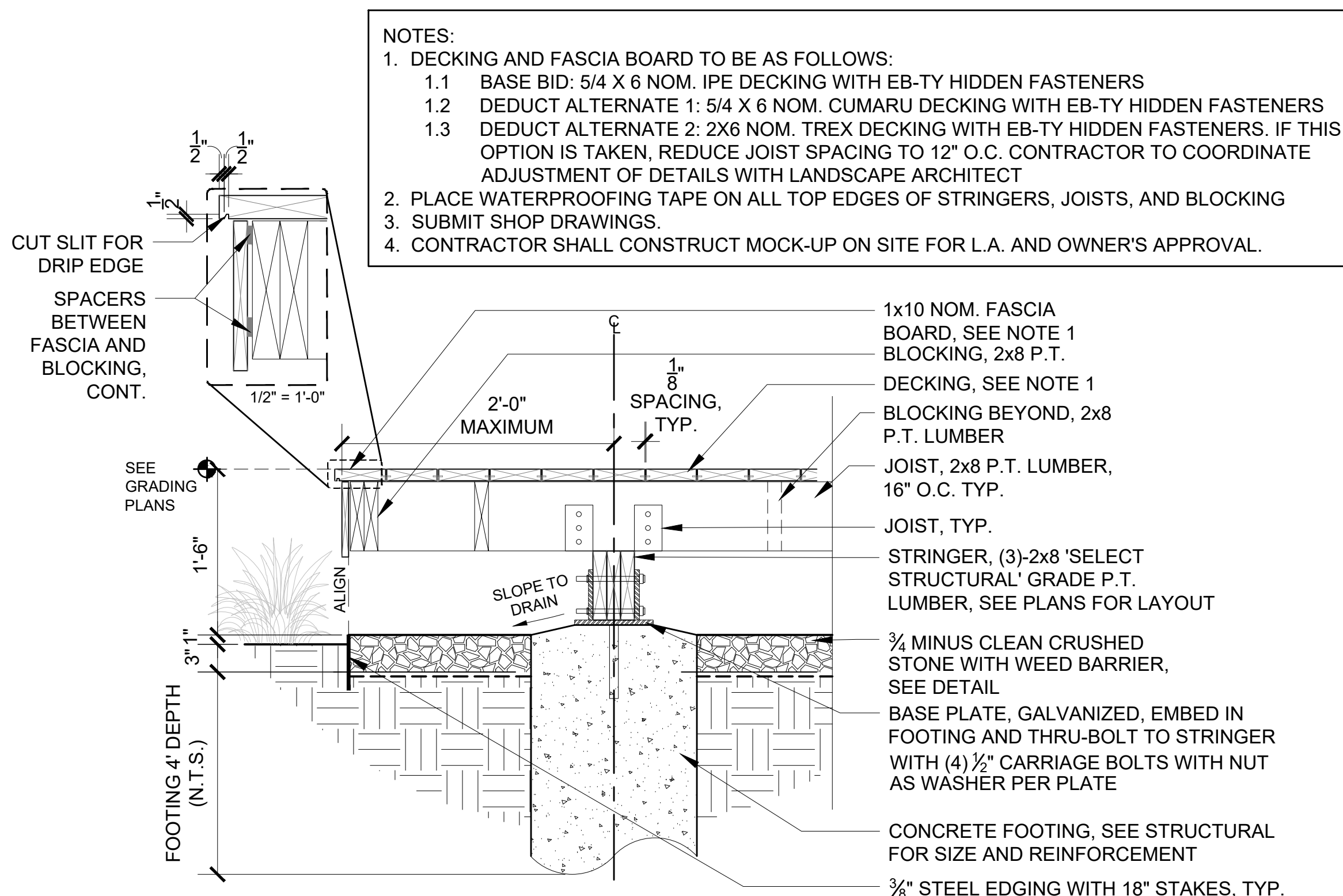

10 WOOD BRIDGE  
1" = 1'-0"



2	8/03/2021	NOI SUBMISSION
1	3/31/2021	SPECIAL PERMIT SUBMISSION
REV	DATE	DESCRIPTION

APPLICANT/OWNER:  
CABOT, CABOT & FORBES  
185 DARTMOUTH STREET  
BOSTON, MA 02116

PROJECT:  
200 QUANNAPOWITT  
PARKWAY  
WAKEFIELD, MA 01880

PROJECT NO. 2021	DATE: 3/16/2021
SCALE: 1" = 10'-0"	DWG. NAME: 200QP.dwg
DESIGNED BY: AD IIR	CHECKED BY: IIR

PREPARED BY:

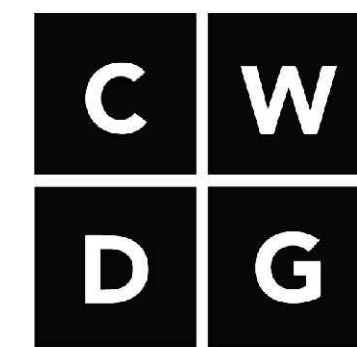

Copley Wolff Design Group  
Landscape Architects & Planners

THIS DRAWING HAS BEEN PREPARED IN DIGITAL FORMAT. CLIENTS REPRESENTATIVE OR CONSULTANTS MAY BE PROVIDED COPIES OF DRAWINGS AND SPECIFICATIONS FOR HIGHER INFORMATION AND/OR SPECIFIC USE ON THIS PROJECT. DUE TO THE POTENTIAL THAT THE PROVIDED INFORMATION MAY BE MODIFIED UNINTENTIONALLY OR OTHERWISE, ALLEN & MAJOR ASSOCIATES, INC. MAY REMOVE ALL INDICATION OF THE DOCUMENTS AUTHORITY ON THE DIGITAL MEDIA. PRINTED REPRESENTATIONS OR PORTABLE DOCUMENT FORMAT OF THE DRAWINGS AND SPECIFICATIONS ISSUED SHALL BE THE ONLY RECORD COPIES OF ALLEN & MAJOR ASSOCIATES, INC.'S WORK PRODUCT.

DRAWING TITLE: SITE DETAILS	SHEET No. L-200
--------------------------------	--------------------

Copyright © 2020 Allen & Major Associates, Inc.  
All Rights Reserved

1/2021 200 QUANNAPOWITT PARKWAY, WAKEFIELD, MA 01880 - COT CONSTRUCTION DRAWINGS, CURRENT CNDG DRAWINGS, 2020COT SITE DETAILS.DWG





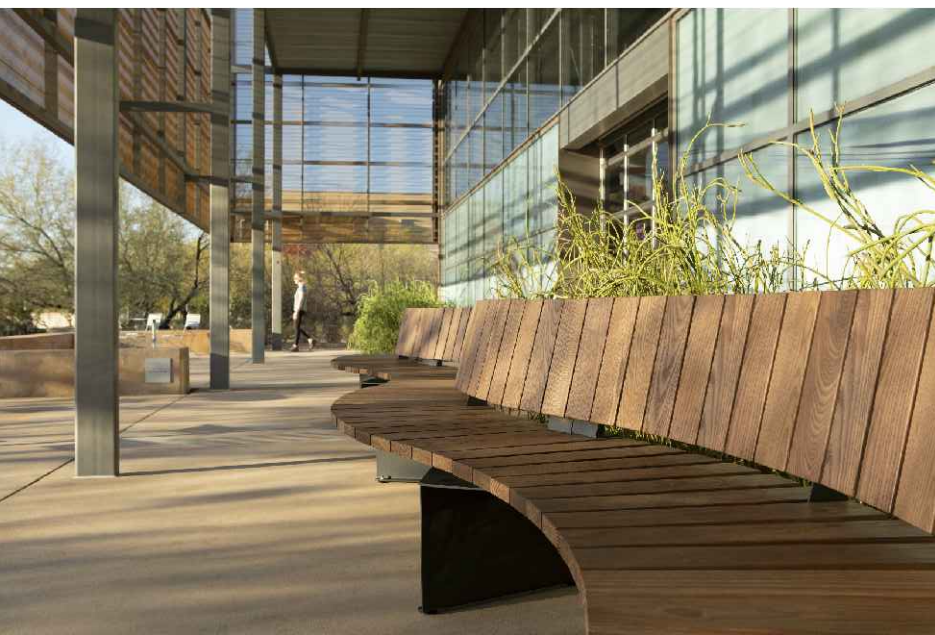

NOTE:  
1. BENCHES ARE TO BE CURVED LINK BENCHES AS MANUFACTURED BY LANDSCAPE FORMS INC. WWW.LANDSCAPEFORMS.COM. PRODUCT REPRESENTATIVE CONTACT: CAROLINA CARAVAJAL EMAIL: CAROLINAC@LANDSCAPEFORMS.COM

1 BENCH  
N.T.S.



NOTE:  
1. LITTER RECEPTACLES ARE TO BE LAKESIDE LITTER RECEPTACLES AS MANUFACTURED BY LANDSCAPE FORMS INC. WWW.LANDSCAPEFORMS.COM. PRODUCT REPRESENTATIVE CONTACT: CAROLINA CARAVAJAL EMAIL: CAROLINAC@LANDSCAPEFORMS.COM

2 LITTER RECEPTACLE  
N.T.S.



NOTE:  
1. BIKE RACKS ARE TO BE LOOPEE BIKE RACKS AS MANUFACTURED BY LANDSCAPE FORMS INC. WWW.LANDSCAPEFORMS.COM. PRODUCT REPRESENTATIVE CONTACT: CAROLINA CARAVAJAL EMAIL: CAROLINAC@LANDSCAPEFORMS.COM

3 BIKE RACKS  
N.T.S.



NOTE:  
1. BOLLARD LIGHTS ARE TO BE STOP BOLLARD LIGHTS AS MANUFACTURED BY LANDSCAPE FORMS INC. WWW.LANDSCAPEFORMS.COM. PRODUCT REPRESENTATIVE CONTACT: CAROLINA CARAVAJAL EMAIL: CAROLINAC@LANDSCAPEFORMS.COM

4 BOLLARD LIGHTS  
N.T.S.



NOTE:  
1. PET STATION IS TO BE A DOGIPOT PET STATION MODEL #1003-L WITH ALUMINUM RECEPTACLE AS MANUFACTURED BY DOGIPOT INC. WEB: WWW.DOGIPOT.COM; PHONE: 800.364.7681.

5 PET STATION  
N.T.S.



T:\2021 200 QUANNAPOWITT PKWY\_WAKEFIELD W CUBES-CGT CONSTRUCTION DRAWINGS CURRENT CNDG DRAWINGS\200QP SITE DETAILS.DWG

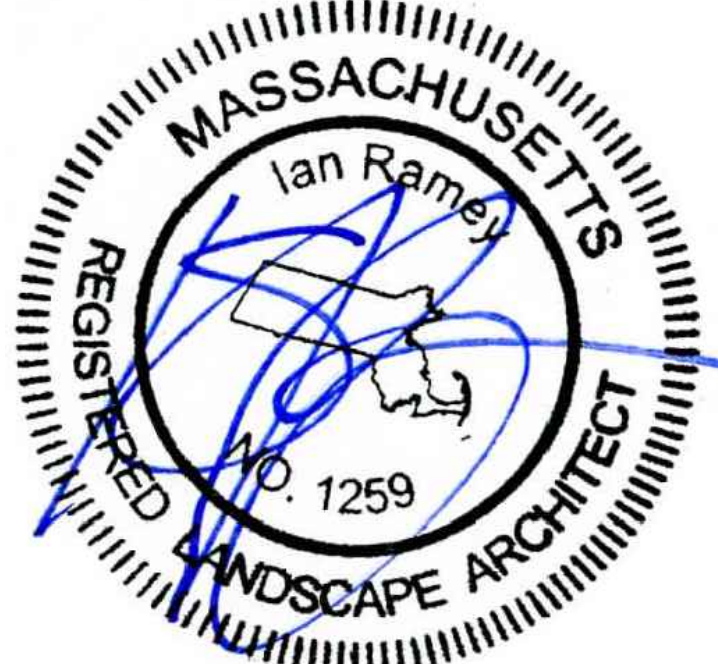

2	8/03/2021	NOI SUBMISSION
1	3/31/2021	SPECIAL PERMIT SUBMISSION
REV	DATE	DESCRIPTION

APPLICANT/OWNER:

CABOT, CABOT & FORBES  
185 DARTMOUTH STREET  
BOSTON, MA 02116

PROJECT:

200 QUANNAPOWITT  
PARKWAY  
WAKEFIELD, MA 01880

PROJECT NO. 2021	DATE: 3/16/2021
SCALE: 1" = 10'-0"	DWG. NAME: 200QP.dwg
DESIGNED BY: AD IIR	CHECKED BY: IIR

PREPARED BY:

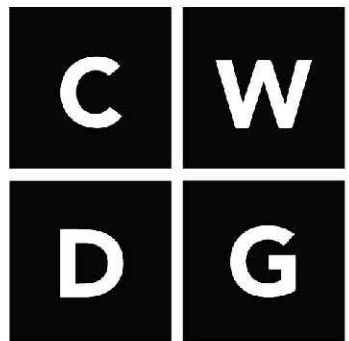

Copley Wolff Design Group  
Landscape Architects & Planners

THIS DRAWING HAS BEEN PREPARED IN DIGITAL FORMAT. CLIENT/CUSTOMER'S REPRESENTATIVE OR CONSULTANTS MAY BE PROVIDED COPIES OF DRAWINGS AND SPECIFICATIONS FOR HIGHER INFORMATION AND/OR SPECIFIC USE ON THIS PROJECT. DUE TO THE POTENTIAL THAT THE PROVIDED INFORMATION MAY BE MODIFIED UNINTENTIONALLY OR OTHERWISE, ALLEN & MAJOR ASSOCIATES, INC. MAY REMOVE ALL INDICATION OF THE DOCUMENT'S AUTHORSHIP ON THE DIGITAL MEDIA. PRINTED REPRESENTATIONS OR PORTABLE DOCUMENT FORMAT OF THE DRAWINGS AND SPECIFICATIONS ISSUED SHALL BE THE ONLY RECORD COPIES OF ALLEN & MAJOR ASSOCIATES, INC.'S WORK PRODUCT.

DRAWING TITLE:	SHEET No.
SITE DETAILS	L-201

Copyright©2020 Allen & Major Associates, Inc.  
All Rights Reserved



